

## SHAD - Sensor Hose Activation Device

# K309-1.11

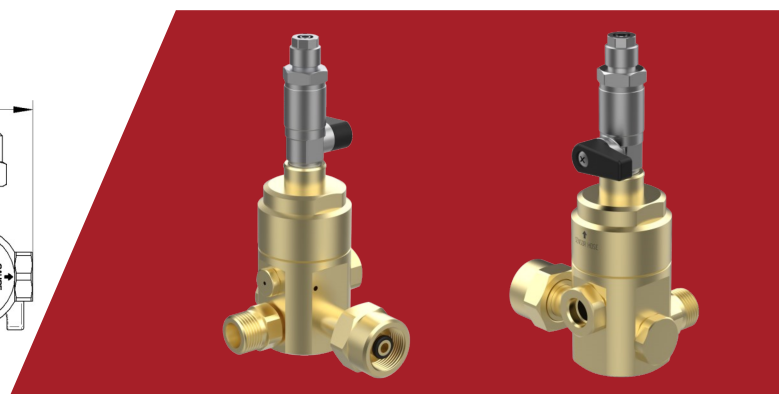
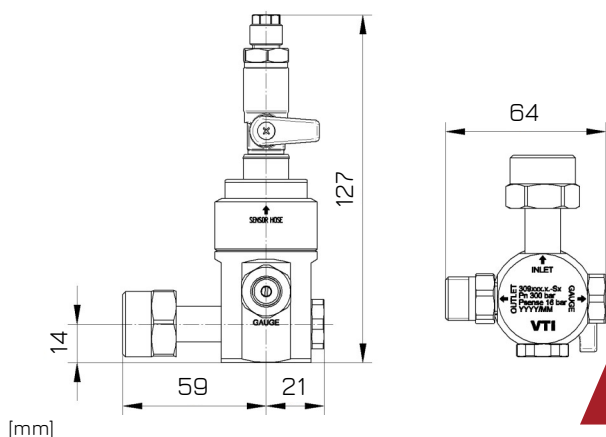

### General Information

Product Area	FIREcontrol
Application	Sensor hose activation device for connection to pneumatically activated standard valves (e.g. K85 valve series)
Mode of Operation	In case of fire, the sensor hose melts. Thereby the control line is pressurized and valve is activated pneumatically
Product Characteristics	<ul style="list-style-type: none"> <li>• Easy plug &amp; play solution</li> <li>• Fast &amp; flexible (dis-)connection</li> <li>• 360° rotatable inlet connection</li> <li>• No external power source needed</li> </ul>

### Technical Data

Extinguishing Type	<ul style="list-style-type: none"> <li>• IG 01 (Argon)</li> <li>• IG 55 (Argon, Nitrogen)</li> <li>• IG 100 (Nitrogen)</li> <li>• IG 541 (Argon, Nitrogen, CO2)</li> <li>• CO2;</li> <li>others on request</li> </ul>
Inlet Port	M18 x 1.25 (suitable for K85 valve series)
Outlet Port (360° rotatable)	M16 x 1.5 acc. to ISO 8434; others on request
Pressure Monitoring Port	G1/8, M10 x 1, M12 x 1; others on request
Working Pressure	30 to 360 bar (in sensor hose: 16-18 bar)
Safety Valve	Activation pressure: max. 35 bar
Working Temperature	-20 °C to +50 °C
Weight	Approx. 650 g
Activation	Thermal

### Materials

Metals	Brass
Polymers	EPDM / PVDF
Lubricants	Based on silicone

### Accessories

For the Outlet Port	K85 connection sets
For the Sensor Hose Port	6x4 sensor hose; others on request
For the Pressure Monitoring port (optional)	Pressure gauge, pressure switch, etc.
Cylinder pressure indicator	Pressure gauge
For the sensor hose	End of line valve, fastening elements, pressure gauge, pressure switch, filling

### Example of use

