

Excess Flow Valve with protection tube

K19-330.0-S1

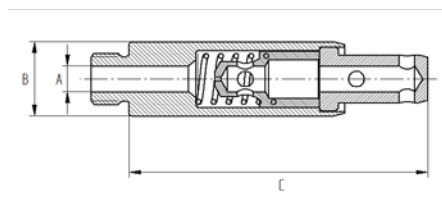

product characteristics

- safety device, which reduces the flow in case of a sudden release of the cylinder content (e.g. by unintentional opening or a broken-off valve) and thus prevents the cylinder from accelerating due to recoil, flying around uncontrollably and causing damages to property and/or injury to persons in the worst case
- the protection tube additionally protects against potential contamination from the cylinder (particles, water etc.) from entering the airways

technical data

product area	AIRcontrol
connection thread	M8x0.75
tightening torque	10 Nm
width across flat	AF10
weight	approx. 26 g
maintenance/service life	inspect at regular intervals (e.g. as part of the cylinder recertification) and replace depending on the inspection results
other	<ul style="list-style-type: none"> • not suitable for diving purposes • fulfills both requirements of the vfdb directive 0810 appendix 02/ DGUV205-014 • BAM-tested (test report DG-03-075)

dimensions

A	ø 4 mm
B	ø 11,7 mm
C	approx. 47 mm

material

metals	brass
--------	-------